



Rookwood Way, London, E3

BUTLER & STAG



Nestled in the heart of Hackney Wick, a dynamic hub renowned for its artistic spirit and eclectic charm, awaits a truly exceptional living experience. Behold this stunning modern one-bedroom apartment, where contemporary elegance meets the serene beauty of canal views.



Leasehold

- Stunning One Bed
- Communal Roof Terrace
- Close to Amenities
- On-Site Gymnasium
- Canal Views
- On-Site Concierge
- Modern & Stylish Throughout
- Secure Bike Storage

Step into a world of refined sophistication as you enter this meticulously designed residence. The open-concept layout seamlessly connects the living, dining, and kitchen areas, creating a fluid space illuminated by natural light streaming through floor-to-ceiling windows.

Inside, the kitchen is a masterpiece of modern design, equipped with high-end appliances and sleek finishes. Whether you're honing your culinary skills or simply enjoying a casual meal, the kitchen effortlessly blends style and functionality.

Retreat to the cozy bedroom, where plush furnishings and soothing tones create a haven of tranquility. Wake up to the gentle lull of the canal and revel in the serenity of your surroundings, knowing that every comfort has been thoughtfully considered.

But the allure of this residence extends beyond its impeccable interior. Residents have exclusive access to a communal roof terrace, a hidden gem offering panoramic views of the city skyline and the shimmering waters below. Whether you're hosting a soirée under the stars or seeking a moment of solitude amidst the urban landscape, the rooftop terrace is the perfect retreat.

Located in the vibrant heart of Hackney Wick, this modern oasis offers unparalleled access to a wealth of cultural attractions, trendy eateries, and artistic venues. Explore the vibrant street art that adorns the neighborhood's walls, or indulge in a leisurely stroll along the scenic canal towpath.

In this captivating enclave, where modern luxury meets urban charm, every moment is an opportunity to immerse yourself in the vibrant energy of city living while savoring the tranquility of waterfront serenity. Welcome to your new home in Hackney Wick, where the beauty of canal views and the allure of a communal roof terrace await.



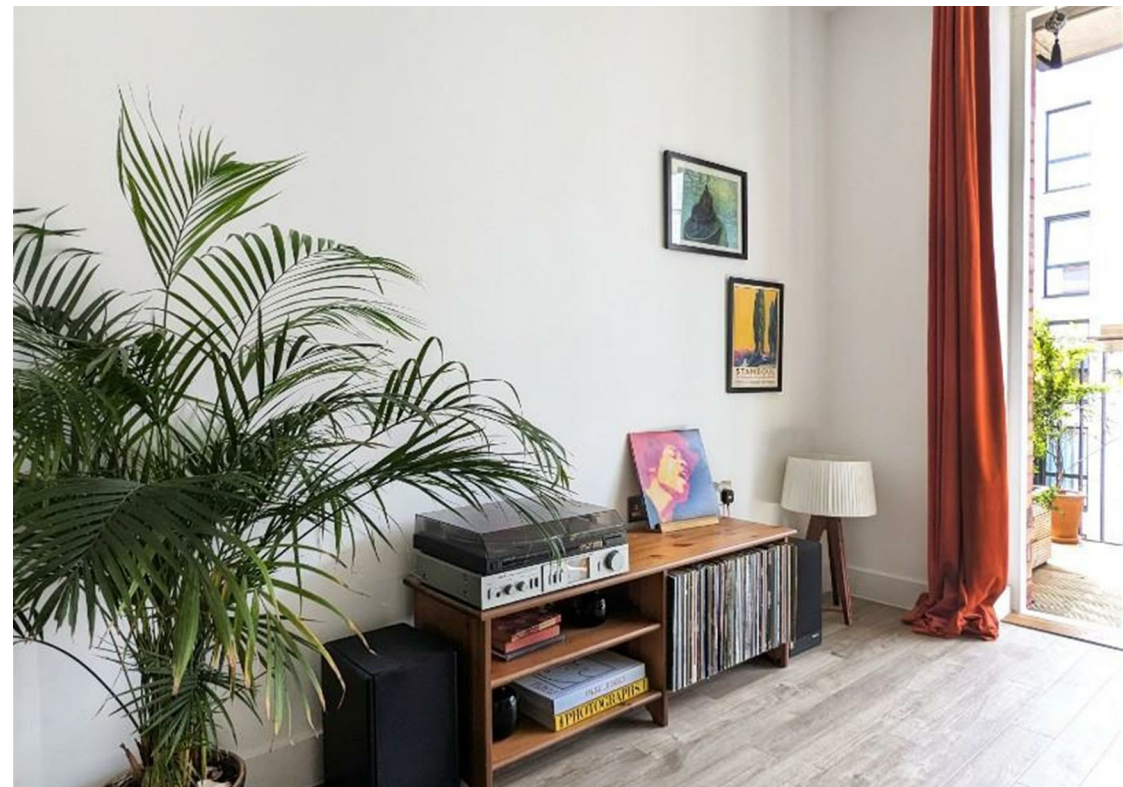

Therm Court

Approx. Gross Internal Area 48 Sq M (517 Sq Ft)

BUTLER & STAG

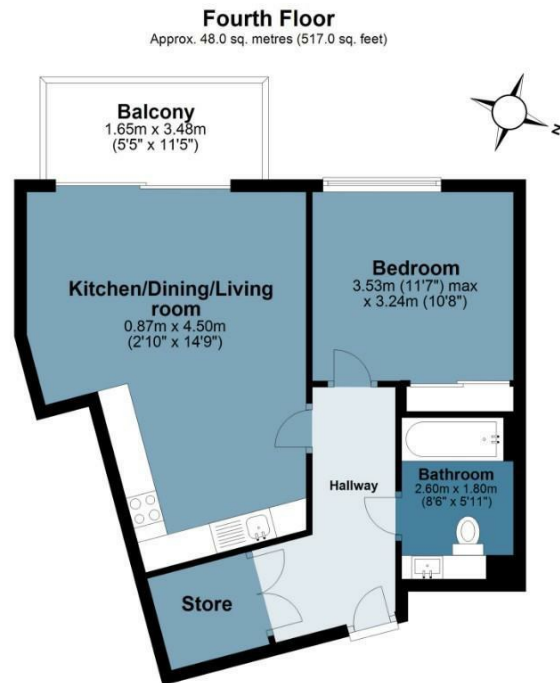

Measurements are approximate and for illustration purposes only. While we do not doubt the accuracy and completeness, we advise you conduct a careful independent assessment of the property to determine monetary value.
© @modephoto.uk www.modephoto.co.uk

IMPORTANT NOTICE - These particulars have been prepared in good faith and they are not intended to constitute part of an offer or contract. We have not performed a structural survey on this property and the services, appliances and specific fittings have not been tested. All photographs, measurements, floor plans and distances referred to are given as a guide and should not be relied upon.

BUTLER & STAG

☎ 020 8102 1236

🏠 508 Roman Road, Bow, London, E3 5LU

✉ bow@butlerandstag.com

www.butlerandstag.uk